

ASK 318.3

Plug-in current transformer

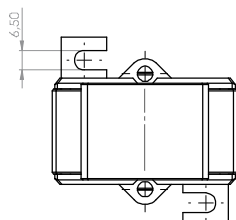

Bus bar 1 31 x 18 mm
 Round conductor 26 mm
 Transformer width 61 mm
 Height 75,5 mm
 Depth 48 mm

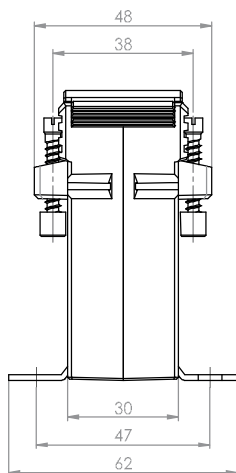
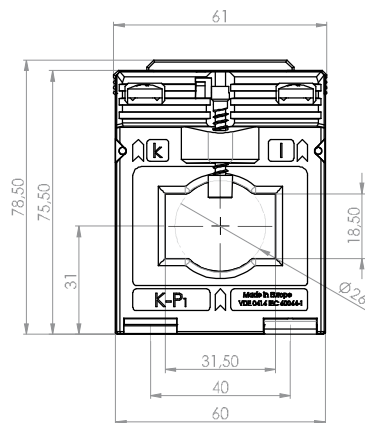

Primary current [A]	Burden [VA]	Secondary current [A] / Class			
		5 A Cl. 1 Art.-no.	5 A Cl. 0,5 Art.-no.	1 A Cl. 1 Art.-no.	1 A Cl. 0,5 Art.-no.
60	1	10029042			
80	1,5	10029045		10029245	
100	1,5	10029047	10029011	10029247	10029211
	2,5	10029048		10029248	
150	1,5	10029049	10029013	10029249	10029213
	2,5	10029050		10029250	10029214
200	2,5	10029052	10029016	10029252	10029216
	3,75	10029054		10029254	
250	5			10029253	
	2,5	10029055	10029019	10029255	10029219
300	5	10029056	10029020	10029256	
	2,5	10029059	10029023	10029259	10029223
400	5	10029060	10029024	10029260	10029224
	2,5	10029063	10029027	10029263	10029227
500	5	10029064	10029028	10029264	10029228
	7,5	10029077		10029277	
600	10	10029065		10029265	
	2,5	10029066	10029030	10029266	10029230
600	5	10029067	10029031	10029267	10029231
	10	10029068		10029268	
600	2,5	10029069	10029033	10029269	10029233
	5	10029070	10029034	10029270	10029234
600	10	10029071	10029035	10029271	10029235

		Art.-no.
	Snap-on mounting, type A	10053011
	Sealed shutter, type A	10059040