

KSU 2...3

Summation current transformer

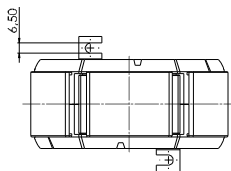

Transformer width 127 mm
 Height 90 mm
 Depth 57 mm

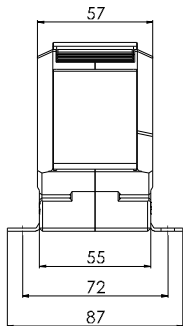
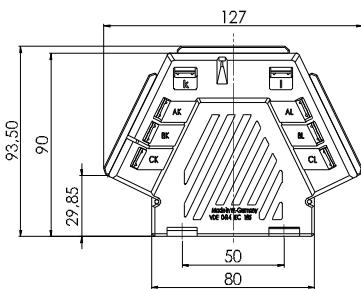

Inputs	Primary current [A]	Secondary current [A] / Class				
		Burden [VA]	5 A Cl. 1 Art.-no.	5 A Cl. 0,5 Art.-no.	1 A Cl. 1 Art.-no.	1 A Cl. 0,5 Art.-no.
2	1	5	10041114	10041111	10041314	10041311
		10	10041115	10041112	10041315	10041312
		15	10041116	10041113	10041316	10041313
		20	10041117		10041317	
	5	25	10041118		10041318	
		5	10041014	10041011	10041214	10041211
		10	10041015	10041012	10041215	10041212
		15	10041016	10041013	10041216	10041213
3	1	20	10041017		10041217	
		5	10041130	10041127	10041330	10041327
		10	10041131	10041128	10041331	10041328
	5	15	10041132	10041129	10041332	10041329
		5	10041030	10041027	10041230	10041227
		10	10041031	10041028	10041231	10041228
	15	10041032	10041029	10041232	10041229	

	Art.-no.
	Snap-on mounting -
	Sealed shutter, type B 10059041

Connection example for different ratios:

- AK-AL = 1000/5
- BK-BL = 800/5
- CK-CL = 600/5

Connection diagram

